

CONTRÔLE TEST

MANOMÈTRE STANDARD - GLYCÉRINE

CORPS LAITON - RACCORD VERTICAL

CLASSE
1.6%



Boîtier inox

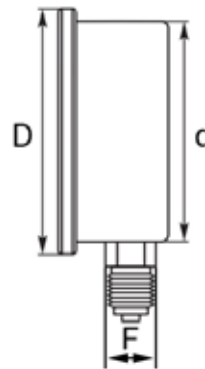

FILETAGE 1/2 GAZ

Référence	d (mm)	D (mm)	Plage (bar)
MV1008K.1+0	100	107	-1 _ 0
MV1008K0+1	100	107	0 _ 1
MV1008K0+1.6	100	107	0 _ 1,6
MV1008K0+2.5	100	107	0 _ 2,5
MV1008K0+4	100	107	0 _ 4
MV1008K0+6	100	107	0 _ 6
MV1008K0+10	100	107	0 _ 10
MV1008K0+12	100	107	0 _ 12
MV1008K0+16	100	107	0 _ 16
MV1008K0+20	100	107	0 _ 20

Référence	d (mm)	D (mm)	Plage (bar)
MV1008K0+25	100	107	0 _ 25
MV1008K0+40	100	107	0 _ 40
MV1008K0+60	100	107	0 _ 60
MV1008K0+100	100	107	0 _ 100
MV1008K0+160	100	107	0 _ 160
MV1008K0+250	100	107	0 _ 250
MV1008K0+315	100	107	0 _ 315
MV1008K0+400	100	107	0 _ 400
MV1008K0+600	100	107	0 _ 600
MV1008K0+1000	100	107	0 _ 1000

FILETAGE 1/4 GAZ

Référence	d (mm)	D (mm)	Plage (bar)
MV0634K.1+0	63	68	-1 __ 0
MV0634K.1+0.6	63	68	-1 __ 0,6
MV0634K.1+1	63	68	-1 __ 1
MV0634K.1+1.5	63	68	-1 __ 1,5
MV0634K.1+3	63	68	-1 __ 3
MV0634K.1+5	63	68	-1 __ 5
MV0634K.1+9	63	68	-1 __ 9
MV0634K0+12	63	68	-1 __ 12
MV0634K.1+15	63	68	-1 __ 15
MV0634K0+0.6	63	68	0 __ 0,6
MV0634K0+1	63	68	0 __ 1
MV0634K0+1.6	63	68	0 __ 1,6
MV0634K0+2.5	63	68	0 __ 2,5
MV0634K0+4	63	68	0 __ 4
MV0634K0+6	63	68	0 __ 6
MV0634K0+10	63	68	0 __ 10

Référence	d (mm)	D (mm)	Plage (bar)
MV0634K0+16	63	68	0 __ 16
MV0634K0+20	63	68	0 __ 20
MV0634K0+25	63	68	0 __ 25
MV0634K0+40	63	68	0 __ 40
MV0634K0+50	63	68	0 __ 50
MV0634K0+60	63	68	0 __ 60
MV0634K0+100	63	68	0 __ 100
MV0634K0+160	63	68	0 __ 160
MV0634K0+200	63	68	0 __ 200
MV0634K0+250	63	68	0 __ 250
MV0634K0+300	63	68	0 __ 300
MV0634K0+315	63	68	0 __ 315
MV0634K0+400	63	68	0 __ 400
MV0634K0+600	63	68	0 __ 600
MV0634K0+1000	63	68	0 __ 1000