

CONTRÔLE TEST MANOMÈTRE STANDARD - GLYCÉRINE CORPS INOX - RACCORD VERTICAL

CLASSE
1.6%

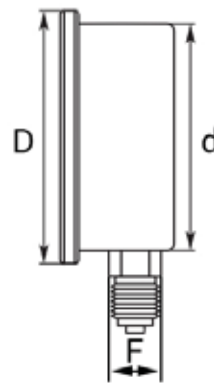

Boîtier inox



FILETAGE 1/2 GAZ

Référence	d (mm)	D (mm)	Plage (bar)
MVX61008K0+1	100	107	0 _ 1
MVX61008K0+2.5	100	107	0 _ 2.5
MVX61008K0+4	100	107	0 _ 4
MVX61008K0+6	100	107	0 _ 6
MVX61008K0+10	100	107	0 _ 10
MVX61008K0+12	100	107	0 _ 12
MVX61008K0+16	100	107	0 _ 16
MVX61008K0+20	100	107	0 _ 20
MVX61008K0+25	100	107	0 _ 25

Référence	d (mm)	D (mm)	Plage (bar)
MVX61008K0+40	100	107	0 _ 40
MVX61008K0+60	100	107	0 _ 60
MVX61008K0+100	100	107	0 _ 100
MVX61008K0+160	100	107	0 _ 160
MVX61008K0+250	100	107	0 _ 250
MVX61008K0+315	100	107	0 _ 315
MVX61008K0+400	100	107	0 _ 400
MVX61008K0+600	100	107	0 _ 600

FILETAGE 1/4 GAZ

Référence	d (mm)	D (mm)	Plage (bar)
MVX60634K0+1	63	68	0 _ 1
MVX60634K0+2.5	63	68	0 _ 2,5
MVX60634K0+4	63	68	0 _ 4
MVX60634K0+6	63	68	0 _ 6
MVX60634K0+10	63	68	0 _ 10
MVX60634K0+12	63	68	0 _ 12
MVX60634K0+16	63	68	0 _ 16
MVX60634K0+20	63	68	0 _ 20
MVX60634K0+25	63	68	0 _ 25
MVX60634K0+40	63	68	0 _ 40
MVX60634K0+60	63	68	0 _ 60
MVX60634K0+100	63	68	0 _ 100
MVX60634K0+160	63	68	0 _ 160
MVX60634K0+250	63	68	0 _ 250
MVX60634K0+315	63	68	0 _ 315
MVX60634K0+400	63	68	0 _ 400
MVX60634K0+600	63	68	0 _ 600